

DIGITAL DESIGN  
GRAPHICS  
TECHNOLOGY

WWW.DDGT.NET

GENERAL NOTES:  
ALL FILLET HAVE R.12"  
UNLESS OTHERWISE  
NOTED  
ALL CHAMFERS ARE .06"  
X 45° UNLESS  
OTHERWISE NOTED

PARTS LIST				
ITEM	QTY	PART NUMBER	MATERIAL	DESCRIPTION
1	1	AXLE	STEEL	
2	1	BUSHING	BRONZE	OILLESS
3	1	HUB	ALUMINUM	
4	1	COLLAR	ALUMINUM	
5	2	PANEL RING	ALUMINUM	.12" UNIFORM THICKNESS
6	1	WHEEL	HARD RUBBER	
7	6	RIVET	STANDARD	∅.31, 1.00" INSIDE LENGTH, EQUALLY SPACED (MCMaster-CARR 97300A709)
8	2	WASHER	STANDARD	I.D. ∅1.00", O.D. ∅2.12, .18" THICK
9	1	SPRING PIN	STANDARD	∅.25", 1.875" LONG (MCMaster-CARR 92383A030)

### LEGEND:

∅ DIAMETER  
R RADIUS  
° DEGREES

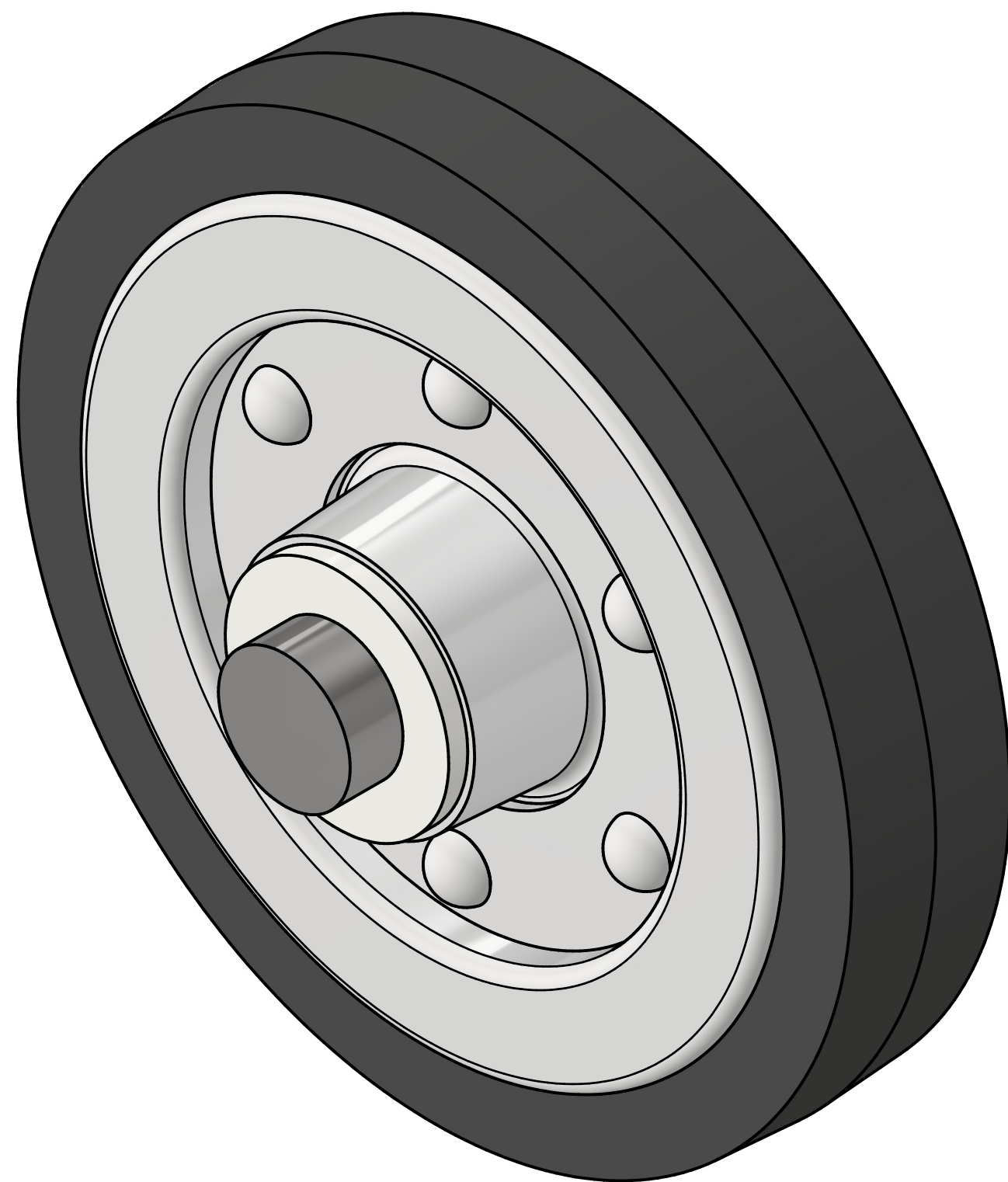

WHEEL ASSEMBLY  
SCALE 1 : 1

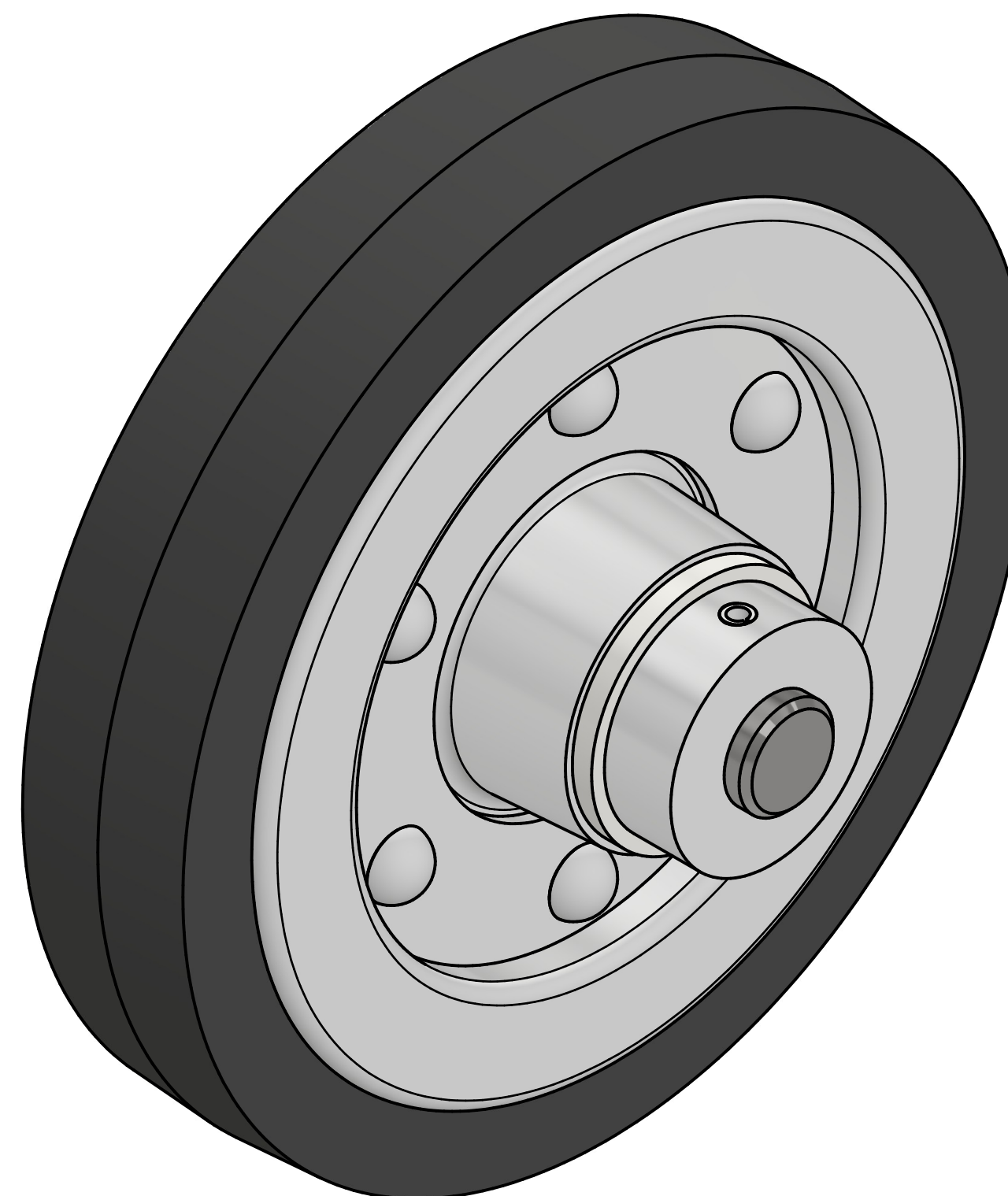

WHEEL ASSEMBLY (ALT VIEW)  
SCALE 1 : 1

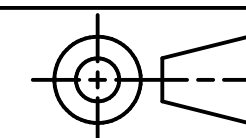

TOLERANCES UNLESS SPECIFIED:  
DECIMAL INCHES  
X = ±.020  
XX = ±.010  
XXX = ±.005  
FRACTIONAL ±1/64"  
ANGLES ±1 DEGREE

SURFACES <sup>32</sup> ✓

CLASS: DDGT-121

ASSIGNMENT #: 11

INVENTOR DRAWING NAME:

WHEEL ASSEMBLY

FIG #: 11-55

MANAGER: G. STROMMEN

DRAFTER: L.MELBY

DATE: 1/23/2026

SCALE: AS NOTED

PAGE #: 1 OF 3

### GENERAL NOTES:

ALL FILLET HAVE R.12" UNLESS OTHERWISE NOTED  
ALL CHAMFERS ARE .06" X 45° UNLESS OTHERWISE NOTED

REV	DATE	DESCRIPTION	APPROVED	SHEET
3	1/28/2026	INSIDE DIAMETER OF PANEL RING CHANGED FROM ∅2.80" TO ∅2.70"	G. STROMMEN	3
2	1/28/2026	CENTER LINE DIAMTER FOR RIVET PATTERN CHANGED FROM ∅3.50" TO ∅3.94	G. STROMMEN	3
1	1/28/2026	TAPER ANGLE ON WHEEL CHANGED FROM 5° TO 3.5°	G. STROMMEN	3

REVISION HISTORY

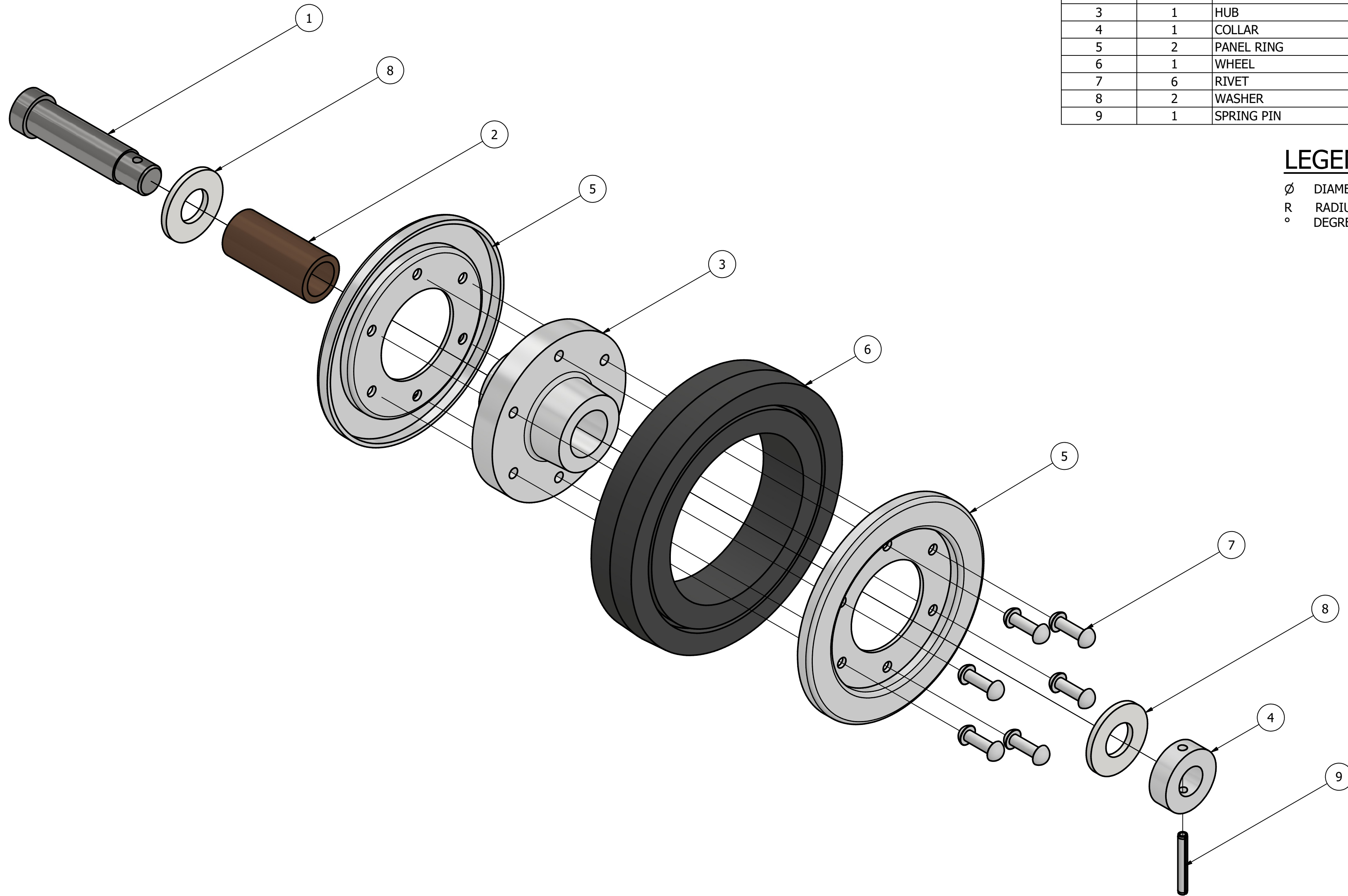

PARTS LIST		
ITEM	QTY	PART NUMBER
1	1	AXLE
2	1	BUSHING
3	1	HUB
4	1	COLLAR
5	2	PANEL RING
6	1	WHEEL
7	6	RIVET
8	2	WASHER
9	1	SPRING PIN

**DDGT**  
 DIGITAL DESIGN  
 GRAPHICS  
 TECHNOLOGY  
 WWW.DDGT.NET

GENERAL NOTES:  
 ALL FILLET HAVE R.12"  
 UNLESS OTHERWISE  
 NOTED  
 ALL CHAMFERS ARE .06"  
 X 45° UNLESS  
 OTHERWISE NOTED

**LEGEND:**  
 ∅ DIAMETER  
 R RADIUS  
 ° DEGREES

WHEEL EXPLODED ASSEMBLY  
 SCALE 1 / 2

**GENERAL NOTES:**  
 ALL FILLET HAVE R.12" UNLESS OTHERWISE NOTED  
 ALL CHAMFERS ARE .06" X 45° UNLESS OTHERWISE NOTED

TOLERANCES UNLESS SPECIFIED:  
 DECIMAL INCHES  
 X = ±.020  
 XX = ±.010  
 XXX = ±.005  
 FRACTIONAL ±1/64"  
 ANGLES ±1 DEGREE

SURFACES <sup>32</sup> ✓

CLASS: DDGT-121  
 ASSIGNMENT #: 11  
 INVENTOR DRAWING NAME:  
 WHEEL ASSEMBLY  
 FIG #: 11-55  
 MANAGER: G. STROMMEN  
 DRAFTER: L.MELBY  
 DATE: 1/23/2026  
 SCALE: AS NOTED  
 PAGE #: 2 OF 3

GENERAL NOTES:  
ALL FILLET HAVE R.12"  
UNLESS OTHERWISE  
NOTED  
ALL CHAMFERS ARE .06"  
X 45° UNLESS  
OTHERWISE NOTED

PARTS LIST		
ITEM	QTY	PART NUMBER
1	1	AXLE
2	1	BUSHING
3	1	HUB
4	1	COLLAR
5	2	PANEL RING
6	1	WHEEL
7	6	RIVET
8	2	WASHER
9	1	SPRING PIN

### LEGEND:

∅ DIAMETER  
R RADIUS  
° DEGREES

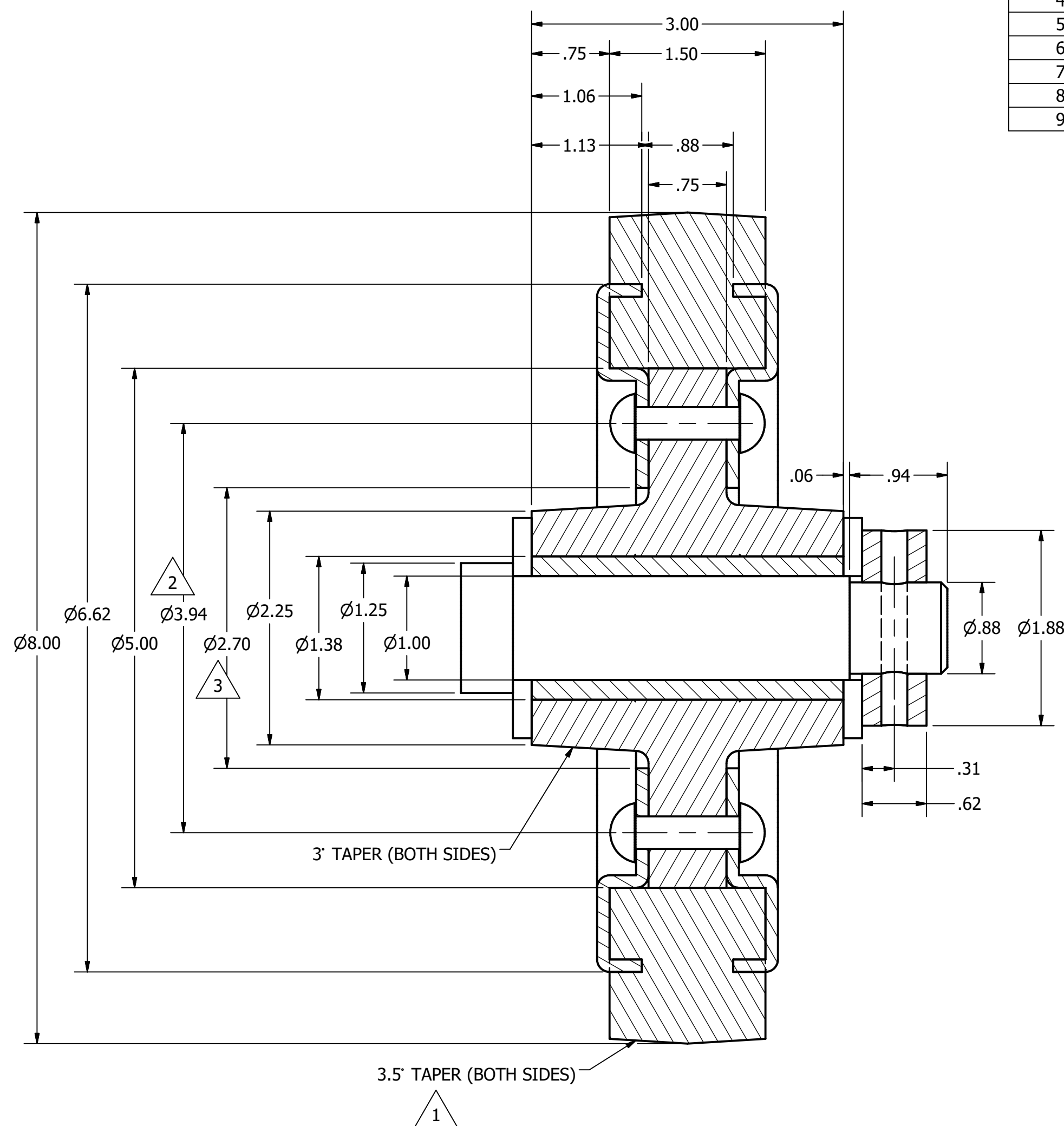

WHEEL SECTION VIEW  
SCALE 1 : 1

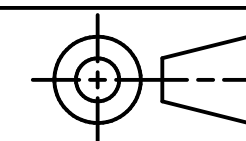

TOLERANCES UNLESS SPECIFIED:  
DECIMAL INCHES  
X = ±.020  
XX = ±.010  
XXX = ±.005  
FRACTIONAL ±1/64"  
ANGLES ±1 DEGREE  
SURFACES <sup>32</sup>✓

CLASS: DDGT-121

ASSIGNMENT #: 11

INVENTOR DRAWING NAME:  
WHEEL ASSEMBLY

FIG #: 11-55

MANAGER: G. STROMMEN

DRAFTER: L.MELBY

DATE: 1/23/2026

SCALE: AS NOTED

PAGE #: 3 OF 3

### GENERAL NOTES:

ALL FILLET HAVE R.12" UNLESS OTHERWISE NOTED  
ALL CHAMFERS ARE .06" X 45° UNLESS OTHERWISE NOTED

REV	DATE	DESCRIPTION	APPROVED
3	1/28/2026	INSIDE DIAMETER OF PANEL RING CHANGED FROM ∅2.80" TO ∅2.70"	G. STROMMEN
2	1/28/2026	CENTER LINE DIAMTER FOR RIVET PATTERN CHANGED FROM ∅3.50" TO ∅3.94	G. STROMMEN
1	1/28/2026	TAPER ANGLE ON WHEEL CHANGED FROM 5° TO 3.5°	G. STROMMEN

REVISION HISTORY